



ASSEMBLY INSTRUCTION

AMALIA 3 SEAT RHF CHAISE

ITEM CODE **72155**

Imported by Amart Furniture Pty Ltd, Qld, Brisbane Australia.
For any assistance with assembly or for missing parts please phone
Amart Customer Service Free call 1800 351 084

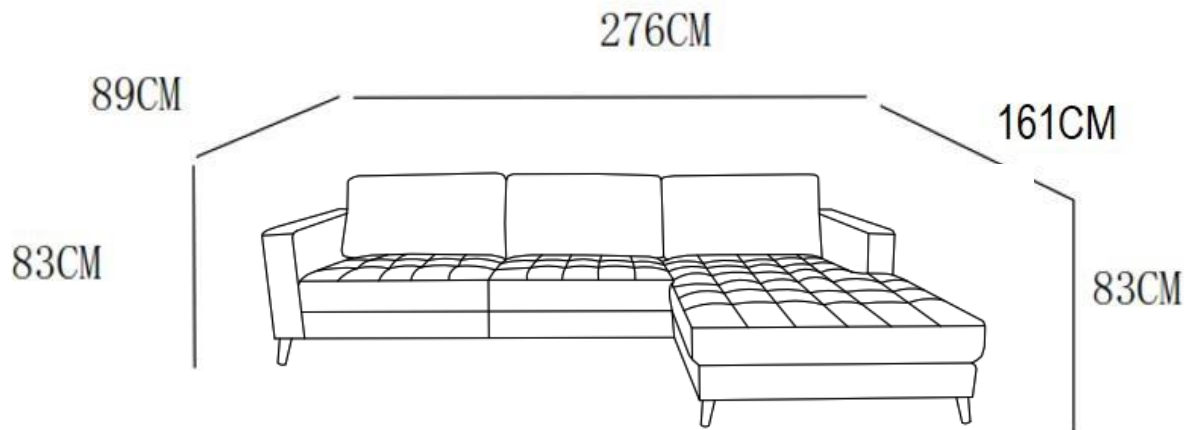

Imported by Amart Furniture Pty Ltd, Qld, Brisbane Australia.

For any assistance with assembly or for missing parts please phone
Amart, Customer Service Free call 1800 351 084

PRE-ASSEMBLY PREPARATION

Before you start:

1. Choose a clean, level, spacious assembly area. Avoid hard surfaces that may damage the product
2. Take care when lifting. Product should be assembled as near as possible to the point of use
3. Ensure that you have all required contents for complete assembly
4. Always read the assembly instructions carefully before beginning assembly.
5. Keep all hardware parts and packaging out of reach of small children.
6. Do not over tighten the screws and bolts as this may damage the threads



ALLOW **10** MINUTES



PEOPLE REQUIRED

PARTS LIST

NO.	Picture	Description	Sofa	Chaise
A	 H=14.5cm	Middle Leg	4pcs	4pcs
B	 M6*14MM	Bolt	8pcs	8pcs
C		Washer	8pcs	8pcs
D		Allen Key	1pc	1pc
E		Plastic Washer	1pc	1pc
F	 H=14.5cm	Metal Leg	1pc	1pc

Hardware and legs are located in dust cover zipper compartment underneath the lounge.

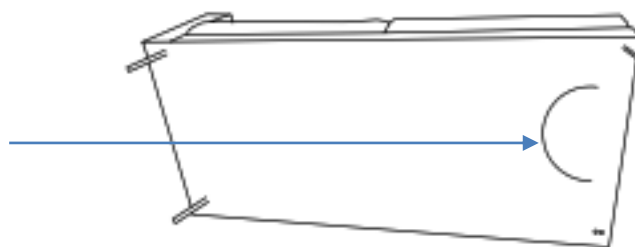

STEP 1: Turn over onto blanket or carpet to ensure no damage to item. Attach legs (A), bolts (B) and washers(E) with Allen key provided and place in to each corner of the sofa and chaise. Attach plastic legs (C) and washer (D) in to the middle of both sofa and chaise turning to secure tightly.

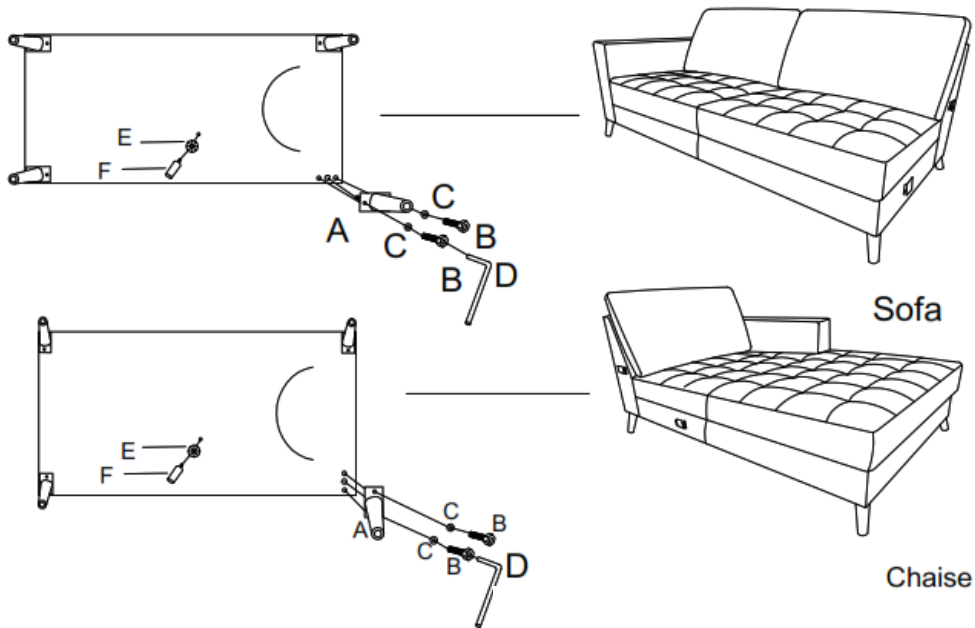

STEP 2: Secure Sofa and chaise together by attaching both alligator connectors together as per image.

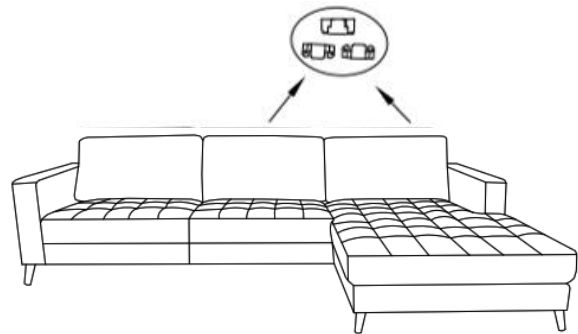

ASSEMBLY IS COMPLETE

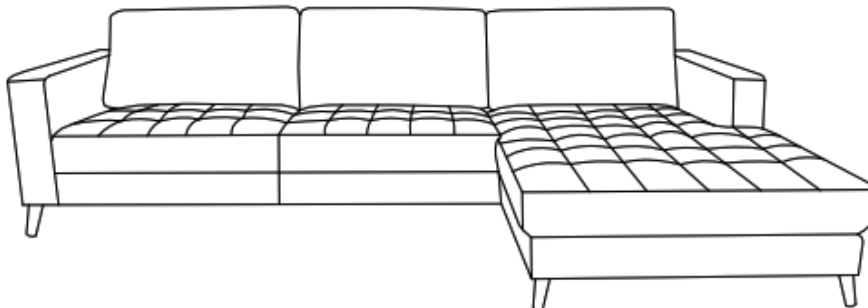

Fabric Care and Maintenance



REGULAR CARE:

- Protect from direct sunlight
- Vacuum regularly using low suction
- Rotate reversible cushions regularly

CLEANING:

- Do not remove cushion covers for separate cleaning even though they may have zippers
- Do not wash, Do not dry clean, Do not shampoo clean
- Clean with hot water extraction machine. Professional cleaning recommended
- Do not use dishwashing liquid or laundry detergent
- Use only upholstery detergents
- Do not wet filling
- Dry in shade away from direct heat and sunlight
- Allow to dry thoroughly before re-use

SPOT CLEANING:

- Do not rub
- Do not spot clean with any solvent
- Treat spills and stains as soon as possible
- Gently scrape off any soil or mop any liquid from the surface of the fabric
- Apply proprietary cleaning agents strictly according to instructions to remove the residue of the spill
- Do not saturate the fabric or interior with water or other cleaning liquids

WARNING:

Apply only water-based soil resist (fabric protection) treatments. Do not use aerosol products

* PILLING IS NOT A FABRIC DEFECT OR FAULT AND IS NOT COVERED BY WARRANTY

* PILLING IS A NORMAL OCCURRENCE CAUSED BY WEAR AND TEAR AND DOES NOT AFFECT THE DURABILITY OR FUNCTIONALITY OF THE FABRIC AND IS EASILY REMOVED